

0003A08x

The flange ends refers to ANSI B15.5
 Face to Face : ANSI B16.10
 Wall Thickness : ANSI B16.34
 Investment casting
 Blow-out proof stem

Full bore
 Class 150 & 300
 15% Glassfiber fill PTFE reinforce seat
 PTFE seal & packing
 Mounting pad

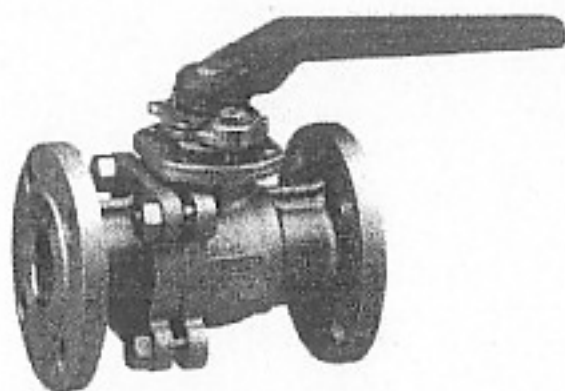

PARTS NAME	MATERIAL
Corpo / Body	AISI 316
Tappo / Cap	AISI 316
Sfera / Ball	AISI 316
Stelo / Stem	AISI 316
Maniglia / Handle	AISI 304
Premistoppa / Gland	AISI 304
Blocco / Stopper	AISI 304
Stud	AISI 304
Dado / Nut	AISI 304
Seggi sfera / Ball seat	R-PTFE
Seggi corpo / Body seal	PTFE
STEM PACKING	PTFE
THRUST WASHER	PTFE

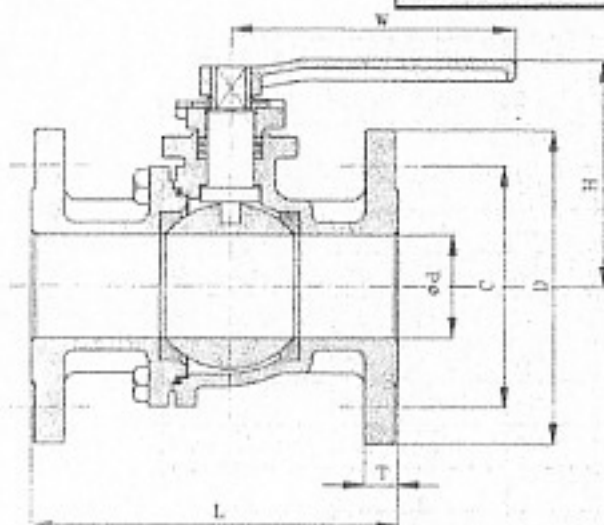
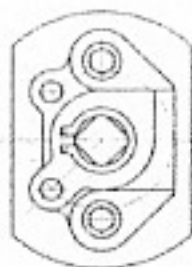

FEATURES

- The flange ends refers to ANSI B15.5
- Face to Face : ANSI B16.10
- Wall Thickness : ANSI B16.34
- Investment casting
- Blow-out proof stem
- Full bore
- Class 300
- 15% Glassfiber fill PTFE reinforce seat
- PTFE seal & packing
- Mounting pad

SIZE	ø d	L	H	W
1/2"	15	140	73	130
3/4"	20	153	76	130
1"	25	165	86	160
1 1/4"	32	178	91	160
1 1/2"	40	190	119	205
2"	50	216	127	205
2 1/2"	65	241	136	325
3"	80	282	164	325
4"	100	305	178	325
5"	125	381	220	760
6"	150	403	254	760
8"	200	502	300	1016
10"	254	568	355	1016