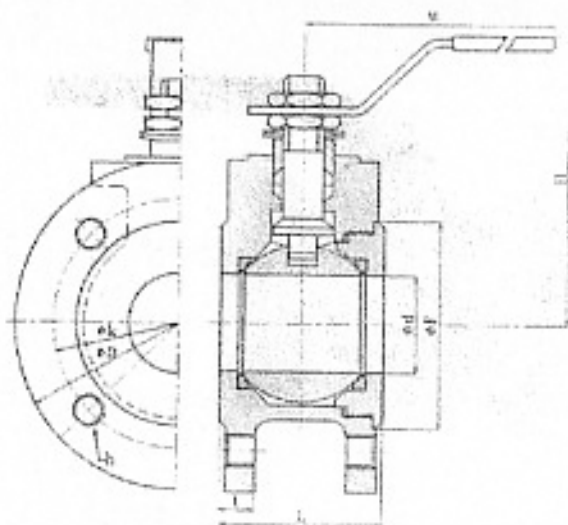
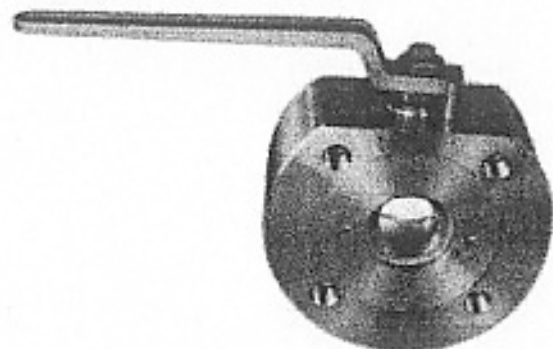

0003Axxx

Valvola a sfera WAFER ricavata da barra in
AISI 316 - AISI 304 - A105
Passaggio TotaleGuarnizioni PTFE caricate 15% vetro
Attacco ISO 5211 per attuatore

SIZE	$\varnothing d$	L	H	W	$\varnothing F$	$\varnothing k$	$\varnothing D$	Nm
1/2"	15	35	57	145	45	65	95	4
3/4"	20	35	65	145	58	75	105	7
1"	25	43	70	170	68	85	115	9
1 1/4"	32	51	75	185	78	100	140	14
1 1/2"	40	64	95	280	88	110	150	25
2"	50	85	105	280	102	125	165	34
2 1/2"	65	103	153	350	122	145	185	50
3"	80	120	163	350	138	160	200	60
4"	100	155	190	420	162	190	235	75
5"								
6"								
8"								

PARTS NAME	MATERIAL
Corpo / Body	AISI 316 - AISI 304 - A105
Tappo / End cap	AISI 316 - AISI 304 - A105
Sfera / Ball	AISI 316 - AISI 304 - A105
Spelo / Stem	AISI 316 - AISI 304 - A105
Maniglia / Handle	AISI 304 - 316
Dado e rondella / Nut & washer	AISI 304 - 316
Seggi sfera / Ball seat	<ul style="list-style-type: none"> • PTFE (G100 -10°C +100°C) • PTFE caricato 20% vetro (G404 -20°C +180°C) • PTFE caricato 23% + 2%carbografite (G453 -40°C +210°C)
Seggi corpo / Body seat	PTFE
Pacco stelo / Stelo packing	PTFE
Seggio stelo / Thrust washer	PTFE
Gomma maniglia / Handle sleeve	VINILE